

Clarke®



12" DISC SANDER

MODEL NO: CDS300B

PART NO: 6500411

OPERATION & MAINTENANCE INSTRUCTIONS



ORIGINAL INSTRUCTIONS

LS0820 - ISS 5

INTRODUCTION

Thank you for purchasing this CLARKE product.

Before attempting to use this product, please read this manual thoroughly and follow the instructions carefully. In doing so you will ensure the safety of yourself and that of others around you, and you can look forward to your purchase giving you long and satisfactory service.

GUARANTEE

This product is guaranteed against faulty manufacture for a period of 12 months from the date of purchase. Please keep your receipt which will be required as proof of purchase.

This guarantee is invalid if the product is found to have been abused or tampered with in any way, or not used for the purpose for which it was intended.

Faulty goods should be returned to their place of purchase, no product can be returned to us without prior permission.

This guarantee does not effect your statutory rights.

FEATURES

This 305 mm disc sander is ideal for finish fitting, altering bevel angles, sanding convex curves - 'to the line', and sanding end grain, without burning etc.

The machine is provided with a work table which is capable of tilting to 45 degrees, and a mitre gauge, in which the work may be held, and which moves in a mitre gauge slot, parallel to the disc. The Mitre gauge is capable of adjustment to 60 degrees. The table must ALWAYS be perfectly secure before starting work.

Considerable dust is produced when using this machine and it is most important that a suitable face mask is worn at all times. We also strongly recommend that a dust extractor is fitted to the outlet provided, and similarly, used at all times.

If you are not familiar with sanding machines, it is strongly recommended that you consult a qualified person, or obtain relevant tutorials. Like all power tools, this machine can be extremely dangerous in the wrong hands or if used incorrectly. Used correctly however, it is a highly efficient and intensely labour saving device.

GENERAL SAFETY RULES



WARNING: WHEN USING ELECTRIC TOOLS BASIC SAFETY PRECAUTIONS SHOULD ALWAYS BE FOLLOWED TO REDUCE THE RISK OF FIRE, ELECTRIC SHOCK AND PERSONAL INJURY INCLUDING THE FOLLOWING. READ ALL THESE INSTRUCTIONS BEFORE ATTEMPTING TO OPERATE THIS PRODUCT AND SAVE THESE INSTRUCTIONS.

1. **Keep work area clear** - Cluttered areas and benches invite injuries.
2. **Consider work area environment** - Do not expose tools to rain, Do not use tools in damp or wet locations., Keep work area well lit. Do not use tools in the presence of flammable liquids or gases.
3. **Guard against electric shock** - Avoid body contact with earthed or grounded surfaces (e.g. pipes, radiators, ranges, refrigerators).
4. **Keep other persons away** - Do not let persons, especially children, not involved in the work touch the tool or the extension cord and keep them away from the work area.
5. **Store idle tools** - When not in use, tools should be stored in a dry locked-up place, out of reach of children.
6. **Do not force the tool** - It will do the job better and safer at the rate for which it was intended.
7. **Use the right tool** - Do not force small tools to do the job of a heavy duty tool. Do not use tools for purposes not intended; for example do not use circular saws to cut tree limbs or logs.
8. **Dress properly** - Do not wear loose clothing or jewellery, they can be caught in moving parts. Non-skid footwear is recommended when working outdoors. Wear protective hair covering to contain long hair.
9. **Use protective equipment** - Use safety glasses. Use face or dust mask if working operations create dust.
10. **Connect dust extraction equipment** - If the tool is provided for the connection of dust extraction and collecting equipment, ensure these are connected and properly used.
11. **Do not abuse the cord** - Never yank the cord to disconnect it from the socket. Keep the cord away from heat, oil and sharp edges.
12. **Secure work** - Where possible use clamps or a vice to hold the work. It is safer than using your hand.
13. **Do not overreach** - Keep proper footing and balance at all times.
14. **Disconnect tools** - When not in use, before servicing and when changing accessories such as blades, bits and cutters, disconnect tools from the power supply.

15. **Maintain tools with care** - Keep cutting tools sharp and clean for better and safer performance. Follow instruction for lubricating and changing accessories. Inspect tool cords periodically and if damaged have them repaired by an authorized service facility. Inspect extension cords periodically and replace if damaged. Keep handles dry, clean and free from oil and grease.
16. **Remove adjusting keys and wrenches** - Form the habit of checking to see that keys and adjusting wrenches are removed from the tool before turning it on.
17. **Avoid unintentional starting** - Ensure switch is in "off" position when plugging in.
18. **Use outdoor extension leads** - When the tool is used outdoors, use only extension cords intended for outdoor use and so marked.
19. **Stay alert** - Watch what you are doing, use common sense and do not operate the tool when you are tired.
20. **Check damaged parts**
 - Before further use of tool, it should be carefully checked to determine that it will operate properly and perform its intended function.
 - Check for alignment of moving parts, binding of moving parts, breakage of parts, mounting and any other conditions that may affect its operation.
 - A guard or other part that is damaged should be properly repaired or replaced by an authorized service centre unless otherwise indicated in this instruction manual.
 - Have defective switches replaced by an authorized service centre.
 - Do not use the tool if the switch does not turn it on and off.



WARNING: THE USE OF ANY ACCESSORY OR ATTACHMENT OTHER THAN ONE RECOMMENDED IN THIS INSTRUCTION MANUAL MAY PRESENT A RISK OF PERSONAL INJURY.

21. **Have your tool repaired by a qualified person** - This electric tool complies with the relevant safety rules. Repairs should only be carried out by qualified persons using original spare parts, otherwise this may result in considerable danger to the user.

ADDITIONAL SAFETY INSTRUCTIONS FOR DISC SANDERS

- ALWAYS place the sander on a solid wood workbench which will not move under load.
- ALWAYS wear safety goggles as protection against flying grit and/or sawdust. In many cases, a full face shield is even better protection. A dust mask is also recommended to keep saw dust out of your lungs.
- ALWAYS clear the work table of all objects except the workpiece (tools, scraps, rulers etc.) before switching on the sander.
- ALWAYS keep your fingers well away from the disc.
- ALWAYS switch off the sander, and make sure the disc has come to a complete stop before clearing sawdust from the table.
- ALWAYS make sure there are no nails or foreign objects in the part of the workpiece to be sanded.
- ALWAYS set up the machine and make all adjustments with the power OFF, and disconnected from the supply.
- ALWAYS use the correct type and size of sanding disc for each operation.
- ALWAYS maintain the smallest gap possible (approximately 3mm) between the sanding disc and the table.
- NEVER operate the machine with the guards or table removed. They must all be in place and securely fastened when performing any operation
- NEVER sand any material that does not have a flat surface on which to bear.
- NEVER force the work into the disc....Hold it FIRMLY and press it gently into the disc, on the DOWNWARD direction side.
- NOTE: The disc spins in an ANTICLOCKWISE direction. The workpiece should ALWAYS be sanded on the LEFT HAND HALF of the disc.

ELECTRICAL CONNECTIONS



WARNING: READ THESE ELECTRICAL SAFETY INSTRUCTIONS THOROUGHLY BEFORE CONNECTING THE PRODUCT TO THE MAINS SUPPLY.

Connect the mains lead to a standard, 230 Volt (50Hz) electrical supply through an approved 13 amp BS 1363 plug, or a suitably fused isolator switch.

If the plug has to be changed because it is not suitable for your socket, or because of damage, it must be removed and a replacement fitted, following the wiring instructions shown below. The old plug must be discarded safely, as insertion into a power socket could cause an electrical hazard.



**WARNING: THE WIRES IN THE POWER CABLE OF THIS PRODUCT ARE COLOURED IN ACCORDANCE WITH THE FOLLOWING CODE:
BLUE = NEUTRAL BROWN = LIVE YELLOW AND GREEN = EARTH**

If the colours of the wires in the power cable do not agree with the markings on the plug.

- The BLUE wire must be connected to the terminal which is marked N or coloured black.
- The BROWN wire must be connected to the terminal which is marked L or coloured red.
- The YELLOW AND GREEN wire must be connected to the terminal which is marked E or \perp or coloured green.

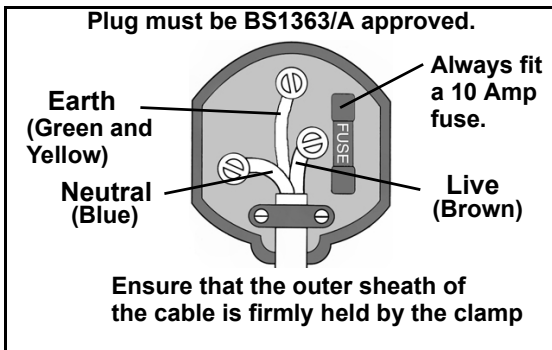

We strongly recommend that this machine is connected to the mains supply through a Residual Current Device (RCD)

If you are not sure, consult a qualified electrician. DO NOT try to do any repairs.

LIST OF CONTENTS.

- 1 x 12" Disc sander
- 1 x 12" Self-adhesive 60 Grit Sanding Disc (fitted)
- 1 x Guide assembly (with protractor)
- 1 x Brake assembly
- 1 x Vacuum hose adaptor

INSTALLATION INSTRUCTIONS

Remove the sander from the packing and ensure it is complete and has not suffered any damage in transit. Should any damage be apparent, contact your Clarke dealer immediately.

POSITIONING THE SANDER

Install the machine on a solid base, one that will not move easily. Ensure that the machine is horizontal and perfectly stable.

Alternatively, the rubber feet may be removed and the machine bolted directly to a solid workbench. This avoids the possibility of the machine moving when in use.

FITTING THE BRAKE

1. Place the brake into position as shown.
2. Secure using the 2 screws provided.

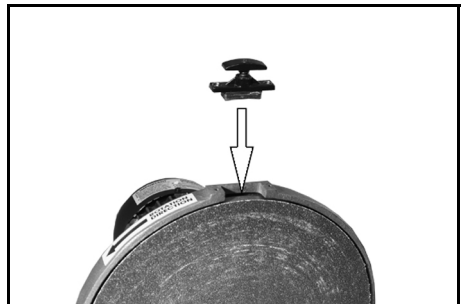

BEFORE FIRST USE

Wipe the table surface with a rag moistened with white spirit to remove any transportation lacquer.

OPERATING INSTRUCTIONS

ADJUSTING THE WORK TABLE

1. Adjust the work table to the desired angle by slackening the two table clamps, one either side,

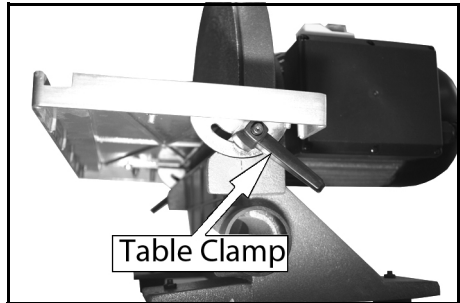

2. Move the table to the required angle.

NOTE: The scale indicating the table angle is to be used as a guide only, please use a calibrated device to get a precise angle.

3. Retighten the clamps.

- The clamps are spring loaded. Turn the lever clockwise to clamp, as far as possible.
- Then pull the lever out against spring pressure which allows the lever to be turned anticlockwise without unclamping.
- Allow the lever to spring inwards again, then proceed to turn it clockwise once more.

NOTE: Repeat the process until the table is securely clamped.....but DO NOT overtighten, otherwise damage to the mechanism will occur.

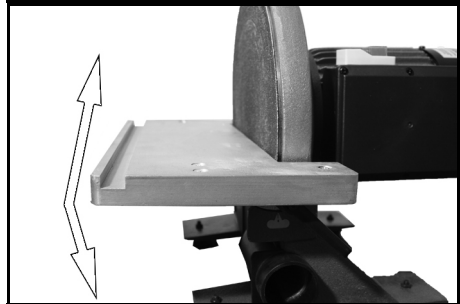

STARTING THE MACHINE

1. Press the GREEN START button marked 'I'.
- Allow the disc to reach full speed before commencing work.

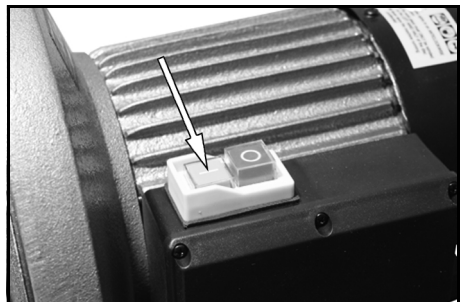

TO STOP THE DISC SANDER

1. Press the RED STOP button marked 'O' and wait for the disc to stop completely before removing any dust.
 - Take care, the disc may take some time to come to a full stop.
 - If required, press the brake on top of the disc sander to help slow the disc.

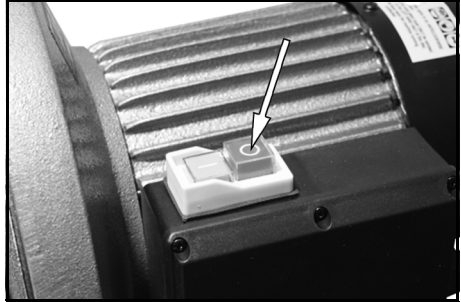

MITRE GAUGE

If the angle is critical, a mitre gauge should be used between the table and disc to ensure accuracy. For right angles, simply slide a square on the table, up to the disc, and adjust accordingly. The angle should be correct when slight pressure is placed on the table.

For greater accuracy, the mitre gauge is used so that the work may be held at a required angle and moved across the disc as shown.

Use a slight pressure ONLY... let the disc do the work. Pressure should be on the DOWNWARDS direction of motion of the disc ONLY. i.e. on the left half of the disc as shown.

NOTE: Applying the workpiece to the right hand side of the disc may cause kickback.

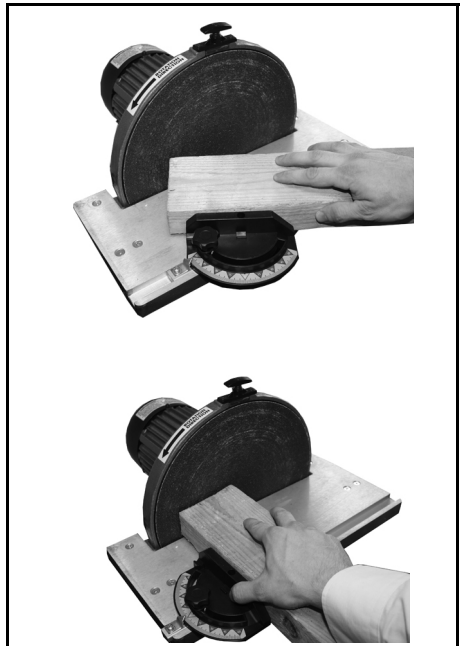

DUST EXTRACTION

We **STRONGLY** recommend that a dust extraction device is used with this machine.

1. Attach a suitable hose from the dust extractor to the outlet, beneath the table.
 - Dust extractors are available from your Clarke dealer).

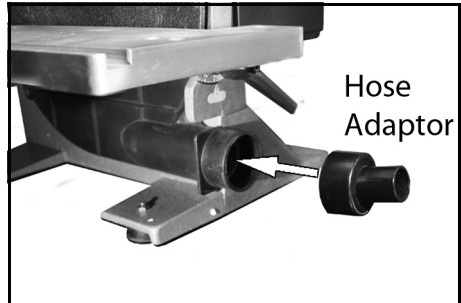

MAINTENANCE AND SERVICING



WARNING: REMOVE THE PLUG FROM THE POWER SUPPLY BEFORE CARRYING OUT ANY ADJUSTMENT, SERVICING OR MAINTENANCE.

The machine is completely maintenance free, with the exception of ensuring it is kept clean and free from build up of sawdust at all times. This should be carried out with an old paintbrush or similar, and a vacuum cleaner.

The panel beneath the table is secured by two screws. Remove these to gain access to the lower half of the disc.

REPLACING SANDING DISCS

Replacement sanding discs (packets of 5) in three different grit sizes are available from your Clarke dealer.

1	60 grit - self adhesive (Packets of 5)	Part No. 6502305
2	80 grit - self adhesive (Packets of 5)	Part No. 6502310
3	120 grit - self adhesive (Packets of 5)	Part No. 6502315

1. Peel off the worn disc from the machine.
2. Remove the protective cover from the back of the new sanding disc.
3. Gently slide it between the work table and disc so that it is concentric about the disc.
4. Press firmly so that it adheres to the disc, turning the disc as you do so.

SPECIFICATION

Motor	230V 50Hz 1Ph
Speed	1490 RPM
Power Rating - On load	900 Watts
Fuse Rating	13 Amps
Disc Size.	305 mm
Dimensions Overall	440 x 437 x 386
Table Size.	437 x 153mm
Table Tilt	0-45° Down
Mitre Gauge	0-60° Both directions
Dust Extraction Outlet ID	46 mm
Dust Extraction Outlet OD	51 mm
Weight unpacked	29.8 kg
Noise Level (no load)	93.4 dB(A)

DECLARATION OF CONFORMITY

Clarke
INTERNATIONAL

Hemnal Street, Epping, Essex, CM16 4LG

DECLARATION OF CONFORMITY

This is an important document and should be retained.

We hereby declare that this product(s) complies with the following directive(s):

- 2014/30/EU Electromagnetic Compatibility Directive
- 2006/42/EC Machinery Directive
- 2017/65/EU Restriction of Hazardous substances (amended by (EU) 2015/863).

The following standards have been applied to the product(s):

- EN 62841-1:2015, EN ISO 12100:2010, EN 61000-3-2:2014, EN 61000-3-3:2013,
- EN 55014-1:2017, EN 55014-2:2015.

The technical documentation required to demonstrate that this product(s) meet(s) the requirement(s) of the aforementioned directive(s) has been compiled and is available for inspection by the relevant enforcement authorities.

The CE mark was first applied in: 2013

Product Description: Disc Sander
Model number(s): CDS300B
Serial / batch Number: N/A
Date of issue: 15/07/2020

Signed:

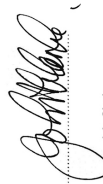

J.A. Clarke
Director

A SELECTION FROM THE VAST RANGE OF

Clarke®

QUALITY PRODUCTS



AIR COMPRESSORS
From DIY to industrial, Plus air tools, spray guns and accessories.

GENERATORS
Prime duty or emergency standby for business, home and leisure.

POWER WASHERS
Hot and cold, electric and engine driven - we have what you need

WELDERS
Mig, Arc, Tig and Spot.
From DIY to auto/industrial.

METALWORKING
Drills, grinders and saws for DIY and professional use.

WOODWORKING
Saws, sanders, lathes, mortisers and dust extraction.

HYDRAULICS
Cranes, body repair kits, transmission jacks for all types of workshop use.

WATER PUMPS
Submersible, electric and engine driven for DIY, agriculture and industry.

POWER TOOLS
Angle grinders, cordless drill sets, saws and sanders.

STARTERS/CHARGERS
All sizes for car and commercial use.



PARTS & SERVICE: 0208 988 7400

Parts Enquiries
Parts@clarkeinternational.com

Servicing & Technical Enquiries
Service@clarkeinternational.com

SALES: UK 01992 565333 or Export 00 44 (0)1992 565335

Clarke INTERNATIONAL Hemnall Street, Epping, Essex CM16 4LG
www.clarkeinternational.com